

CKTS	DMA	DMA8	DMC	DMD
04	3.00	5.10	8.30	9.90
05	4.00	6.10	9.30	10.90
06	5.00	7.10	10.30	11.90
07	6.00	8.10	11.30	12.90
08	7.00	9.10	12.30	13.90
09	8.00	10.10	13.30	14.90
10	9.00	11.10	14.30	15.90
11	10.00	12.10	15.30	16.90
12	11.00	13.10	16.30	17.90
13	12.00	14.10	17.30	18.90
14	13.00	15.10	18.30	19.90
15	14.00	16.10	19.30	20.90
16	15.00	17.10	20.30	21.90
17	16.00	18.10	21.30	22.90
18	17.00	19.10	22.30	23.90
19	18.00	20.10	23.30	24.90
20	19.00	21.10	24.30	25.90
21	20.00	22.10	25.30	26.90
22	21.00	23.10	26.30	27.90
23	22.00	24.10	27.30	28.90
24	23.00	25.10	28.30	29.90
25	24.00	26.10	29.30	30.90
26	25.00	27.10	30.30	31.90
27	26.00	28.10	31.30	32.90
28	27.00	29.10	32.30	33.90
29	28.00	30.10	33.30	34.90

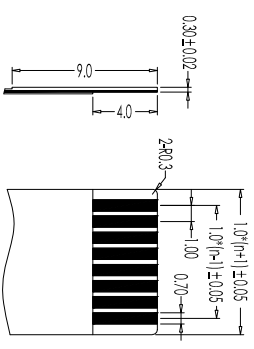

Proper Cable(Scale 2:1)

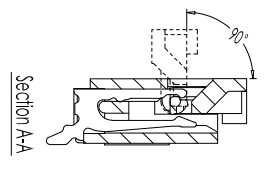
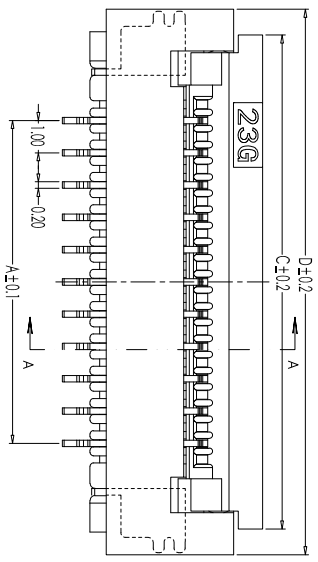
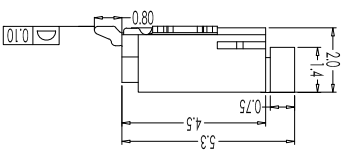
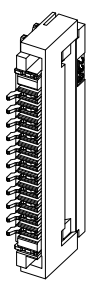
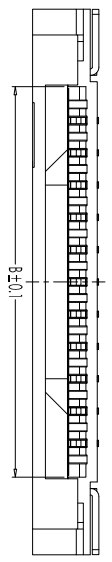
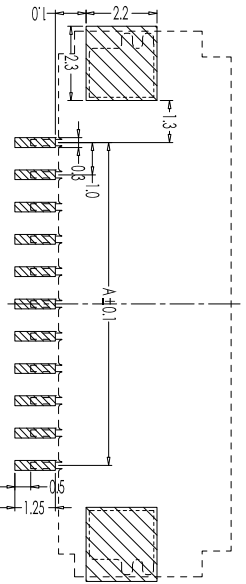

Recommended P.C.B Layout
(PCB Board Tolerance ±0.05)

- NOTES:
1. Current Rating: 0.4A AC/DC
 2. Voltage Rating: 50V AC/DC
 3. Temperature Range: -25°C to 85°C
 4. Contact Resistance: 20mΩ Max.
 5. After Environmental Testing: 40mΩ Max.
 6. Insulation Resistance: 500MΩ min.

F - 100 K XX B - LP P T - W 5 Z - X

- ① ② ③ ④ ⑤ ⑥ ⑦ ⑧ ⑨ ⑩ ⑪ ⑫
- ① F=FC/FPC Connector
- ② 100=Pitch 1.00mm
- 3 K=K Type Series
- ④ XX= No of Contacts
- ⑤ B=Bottom Contact Type/I=Top Contact Type/R=Vertical Right Contact Type/V=Vertical Left Contact Type/S=Single Contact Type/D=Dual Contact/N=Indiscriminate
- ⑥ PT=PT/66= NYLON 66/46= NYLON 46/6T= NYLON 6T/9T= NYLON 9T/1P=LCP/PP=PPS
- ⑦ B=Brass/P=Phosphor Bronze/H=High conductivity copper/R=Red copper/C=Copper Alloy
- ⑧ Surface Processing:0=None/I=In Bright/G=Gold Flash Plating/N=Nickel Plating/=In Matte/2=3u" Gold/3=5u" Gold/4=6u" Gold/5=10u" Gold/6=15u" Gold/7=20u" Gold/8=30u" Gold/9=Silver Plating/H=Half of Gold Tin
- ⑨ V=Vertical Dip type/R=Right Angle Dip type/L=Vertical SMT type/W=Right Angle SMT Type/S=Special P.C.B Model
- ⑩ Insulator Height:1=0.90mm/2=1.00mm/3=1.20mm/4=1.50mm/5=2.00mm/6=2.70mm/7=3.00mm/8=5.00mm/N=Indiscriminate/A=2.50mm
- ⑪ N=Non-ZIF type/Z=ZIF Type
- ⑫ Packaging: 1=PE bag/2=tube/3=Reel/4=Hot Tape&Reel/5=Reel+CAP/6=Reel+MW/or/7=PC Tray/8=tube+CAP/9=tube+MW/or

④	Fitting Nail	Copper Alloy/ Sn/Au overnickel	2 PCS	A050AZ-TSAR-202
③	Terminal	Phosphor Bronze/ Sn/Au overnickel	CKTS PCS	A050AZ-TTEG-201
②	Latch	LCPJU94-V0/Color: Black	1 PCS	A123AZ-CLAT-102
①	Housing	LCPJU94-V0/Color: Nature	1 PCS	A050AZ-CHSG-101
Item	Parts Material	Specification	Qty	Note

Rev.	修正: Revisions	公差: Tolerances- Unless otherwise specified	機型 Model	-	核准 Approved:lan	日期 Date	圖名 Description:
A.01	SR-1.0K-DX-nPWB-xxx Tony 2019/05/16	公差: 0.25 0.20 ±.5	客體 Customer P/N	-	審核 Checked	07/21/20	ZIF FOR FCC/PPC PH1.00
A.02	变更料号 Tony 2020/07/21	公差: ±0.20/0.80-±.0	盛瑞料號 Part No.	F-100KX8-LPPT-MW5Z-X	安規 Safety	郑漢 07/21/20	mm ASSY(掀盖式D type)
		公差: ±.5°	Environmental standard	RoHS	製圖 Draw	Tong 07/21/20	下接式

TEL: 86-769-8216714/87988775 MAIL: srco@dsrco.com

THIS DRAWING CONTAINS INFORMATION THAT IS PROPRIETARY TO SHENGHUI INCORPORATED AND SHOULD NOT BE USED WITHOUT WRITTEN PERMISSION.

SRCO 东莞市盛瑞科技有限公司
Dongguan Shengrui Technology Co., Ltd.