

PCB Layout Diagram
Top View

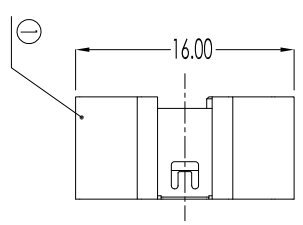

- NOTES:
1. Contact Resistance: 30 milliohms Max.
 2. Insulation Resistance: 1000 Mega Ohms
 3. Dielectric Voltage: 500V AC one second.
 4. Operating Temperature: -25° C to 85° C

- H - 2450 02 - xx P G - L 2 - x
- ① ② ③ ④ ⑤ ⑥ ⑦ ⑧ ⑨
- ① H=Battery Holder Connector
 - ② 2450=2450 Type
 - ③ 00=General(標準一般)/01=01 type/02=02 type/03=03 type/04=04 type
 - ④ PT=PBT/66=Nylon66/46=Nylon46/9T=Nylon9T/LP=LCP/PP=PPS
 - ⑤ C=Copper/P=Phosphor bronze/H=High conductivity copper/S=Stainless steel/M=Mu Steel
 - ⑥ T=Tin plating/G=Gold flash plating/1=3U" gold/2=5U" gold/3=10U" gold/4=14U" gold/5=20U" gold/6=30U" gold/7=Nickel plating/S=Silver plating
 - ⑦ V=Vertical Dip type/R=Right Angle Dip type/L=Vertical SMT type/W=Right Angle SMT type/S=special P.C.B Module
 - ⑧ 1=Black/2=White/3=Brown
 - ⑨ 1=PE Bag Packing/2=Tube Packing/3=Tape Reel Packing/4=Hot Tape Reel Packing/5=PVC Tray Packing

Item	Parts Material	Specification	Qty	Note
③	Terminal(-)	Phosphor Bronze; ±0.15mm /Gold Plating(10U" -120U")	1 PCS	24502A-HTE-202
②	Terminal(+)	Phosphor Bronze; ±0.15mm /Gold Plating(10U" -120U")	1 PCS	24502A-HTE-201
①	Housing	LCP UL94V-0 / Color:White	1 PCS	24502A-HSG-101

Rev.	修正 Revisions	Unless otherwise specified
A.01	SRBS-24-B4A-A01 6-SMT Tony 2016/11/10	公差: 未标注公差 标注公差
A.02	变更料号 Tony 2020/07/21	XX: ±0.25 0~20: ±0.5 XXX: ±0.20 20~80: ±1.0 X.X: ±1° L: ±4.90 ±20

SRCO 东莞市盛瑞科技有限公司
Dongguan Shengrui Technology Co., Ltd.
TEL: 86-769-8216714/87988875 MAIL: srco@qdsrco.com

THIS DRAWING CONTAINS INFORMATION THAT IS PROPRIETARY TO SHENGRUI INCORPORATED AND SHOULD NOT BE USED WITHOUT WRITTEN PERMISSION.

機型 Model	客號 Customer P/N	審核 Approved Tian	圖名 Description:
盛瑞料號 Part No.	-	07/21/20	Battery CR2450-2 SMT Au
Environmental standard	H-245002-1PR-G-12-X	07/21/20	
RoHS	RoHS	Tong 07/21/20	
單位 Unit:mm 比例 Scale: 1/1	Third angle projection	頁碼 Page 1/1	