

CCS	DMA	DM8
02	2.54	5.08
03	5.08	7.62
04	7.62	10.16
05	10.16	12.70
06	12.70	15.24
07	15.24	17.78
08	17.78	20.32
09	20.32	22.86
10	22.86	25.40
11	25.40	27.94
12	27.94	30.48

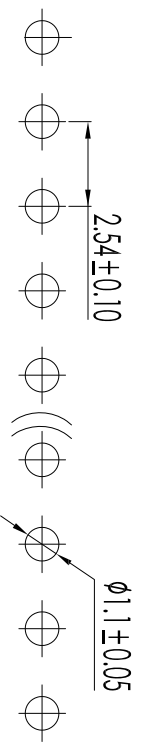
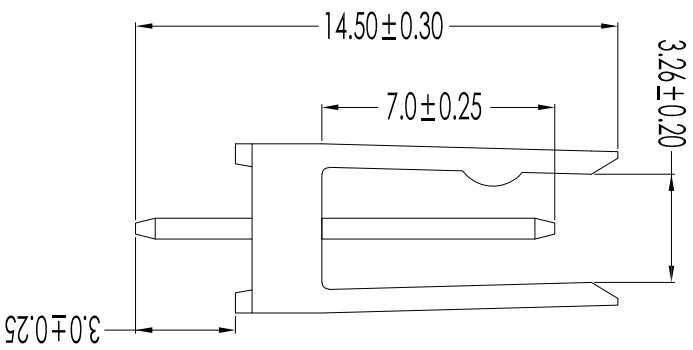
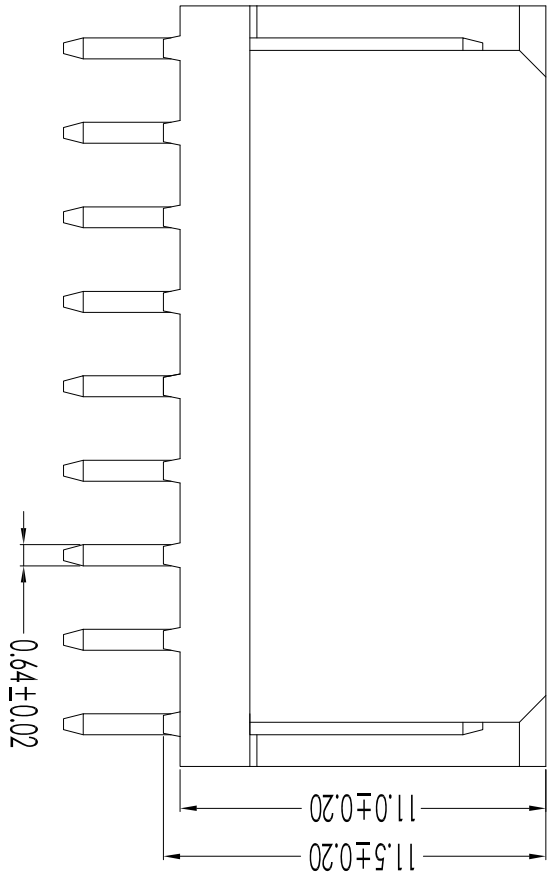
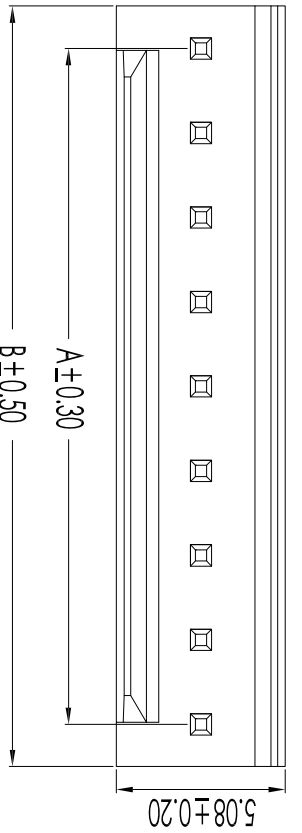

Recommended P.C.B Layout
[PCB Board Tolerance ±0.05]

Item	Parts Material	Specification	Qty	Note
①	Insulator	Nylon66/UL 94V-2/Color: Black	×	P254T-020-6601
②	Contact	Boss/Gold/Tin flash all over nickel	×	P254T-064-01GF

Rev.	修正 Revisions
A.01	SR-254-V1XX-1X-H/ULH Tony 2019/05/16
A.02	变更料号 Tony 2020/07/21

- Tolerances - Unless otherwise specified	
XX	: ±0.30
XXX	: ±0.20
XXXX	: ±0.10
XX	: +2°

SRCO 东莞市盛瑞科技有限公司
Dongguan Shengrui Technology Co., Ltd.
TEL: 86-769-8216714/87988775 MAIL: src@dsrco.com

机型 Model	客議 Customer P/N	盛瑞料號 Part No.	Environmental standard	單位 Unit:mm	比例 Scale	Third angle projection
-	-	A-25403CWS-66X-VU-X	RoHS	mm	1:1	Third angle projection

核准 Approved:lan	日期 Date	審核 Checked	日期 Date	製圖 Draw	日期 Date	頁碼 Page	圖名 Description
	07/21/20		07/21/20	Tony	07/21/20	1/1	2.54mm Crimp Style Connector

- NOTES:
- Current Rating: 3A AC/DC
 - Voltage Rating: 250V AC/DC
 - Temperature Range: -40° C to 105° C
 - Contact Resistance: 20mΩ Max.
 - Insulation Resistance: 1000MΩ Min.
- A - 254 05 C XX S - 66 B X - V U - X
- ① A=Board to Wire Connector
 - ② 254=Pitch 2.54mm
 - ③ 05=PH2.54 Style Series
 - ④ C=Connector/H=Housing/T=Terminal
 - ⑤ XX= No. of Contacts
 - ⑥ S=Single Row/D=Dual Row/A=Assembly
 - ⑦ PT=PPBT/66= Nylon 66/46= Nylon 46/
 - ⑧ 61= Nylon 61/91= Nylon 91/P=PC/PS=PPS
 - ⑨ C=Copper Alloy/B=Brass/P=Phosphor Bronze/H=High conductivity copper
 - ⑩ Plating=NONE/T=Tin Bright/G=Gold Flash Plating/I=Tin Matte
/Z=3u" Gold/S=5u" Gold/L=10u" Gold/5=15u" Gold/6=20u" Gold/
7=30u" Gold/8=NICKEL Plating/S=Silver Plating/H=Hard of Gold Tin
 - ⑪ V=Vertical Dip Type/R=Right Angle Dip Type/L=Vertical SMT
Type/W=Right Angle SMT Type/S=Special P.C.B. Module
 - ⑫ 0=Straight/L=1 Type/Z=2 Type/3=3 Type/U=U Type
Packaging: 1=PE bag/2=Tube/3=Tape Reel/7=PVC Tray/
8=Tube+CAP