

- NOTES:
1. Current Rating: 20A AC/DC
 2. Voltage Rating: 250V AC/DC
 3. Temperature Range: -25° C to 85° C
 4. Contact Resistance: 10mΩ Max.
 5. Insulation Resistance: 30mΩ Max. After environmental testing: 1000MΩ min.
 6. Withstanding Voltage: 800V AC/minute

- A - 200 01 T M - P X - 3
- ① ② ③ ④ ⑤ ⑥ ⑦ ⑧
 - ① A-Board to Wire Connector
 - ② 200=Pitch 2.0mm
 - ③ 01=01(PH) Type Series
 - ④ C=Connector/H=Housing/I=Terminal
 - ⑤ 0=Standard Type/1=I Type/2=I Type/M=Male Type/F=Female Type
 - ⑥ B=Brass/P=Phosphor Bronze/H=High Conductivity Copper/R=Red copper
 - ⑦ T=Tin Plating /G=Gold flash Plating / 1=3U" Gold Plating / 2=5U" Gold Plating / 3=10U" Gold Plating / 4=15U" Gold Plating / 5=20U" Gold Plating / 6=30U" Gold Plating / 7=Nickel Plating / S=Silver plating
 - ⑧ 3=Iape&Reel Pocking

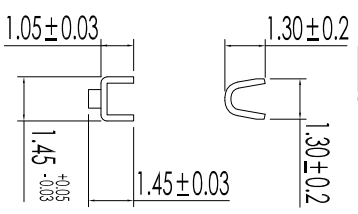

Item	Parts Material	Specification	Qty	Note	P/N
①	Terminal Phosphor Bronze:CS191-EH /Tin-Plated / AWG#24-#30 / Insulation O.D. 1.40mm Max.		8,000 PCS	A20001-T-201	

Rev.	修正 Revisions
A.01	A200A-TM Tony 2019/05/16
A.02	变更料号 Tony 2020/07/21

Unless otherwise specified

SRCO 东莞市盛瑞科技有限公司
Dongguan Shengrui Technology Co., Ltd.
TEL: 86-769-8276714/87988875 MAIL: srco@qdsrco.com

Rev.	修正 Revisions
A.01	A200A-TM Tony 2019/05/16
A.02	变更料号 Tony 2020/07/21