

CTS	DMA	DM8	DMC	DMD
02	1.50	6.95	3.95	5.55
03	3.00	8.45	7.45	7.05
04	4.50	9.95	8.95	8.55
05	6.00	11.45	10.45	10.05
06	7.50	12.95	11.95	11.55
08	10.50	15.95	14.95	14.55
10	13.50	18.95	17.95	17.55
11	15.00	21.95	20.95	20.55

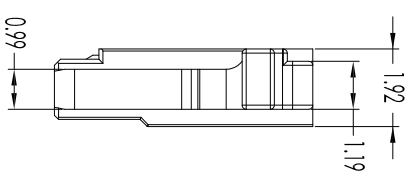

- NOTES:
1. Current Rating: 30A AC/DC
  2. Voltage Rating: 350V AC/DC
  3. Temperature Range: -25° C to 85° C
  4. Contact Resistance: 20mΩ Max.
  - After environmental testing: 40mΩ Max.
  5. Insulator Resistance: 500MΩ min.
  6. Withstanding Voltage: 500V AC/minute

- ① A - Board to Wire Connector
- ② 150=Pitch 1.50mm
- ③ 06=02(Mx Ultra-thin) Type Series
- ④ C=Connector/H=Housing/T=Terminal
- ⑤ xx=No. of Contacts
- ⑥ 0=Standard/M= Male/F=Female
- ⑦ S=Single Row Type/D=Dual Row Type
- ⑧ PT=PT/66= Nylon 66/46= Nylon 46/6T= Nylon 6T/9T= Nylon 9T/LP= LCP/PS=PPS
- ⑨ 0=General(通常一般用)/Z=Latch Type/M=Male type/F=Female Type
- ⑩ 1=PE Bag Packing

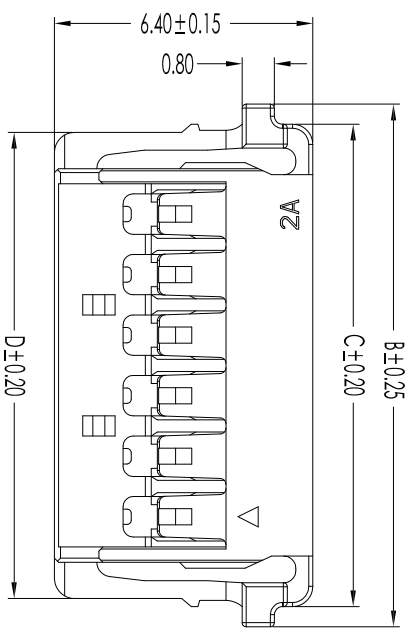
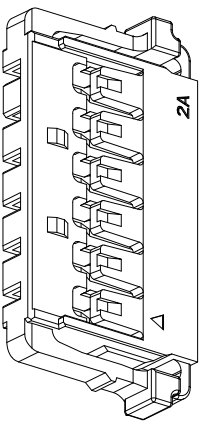
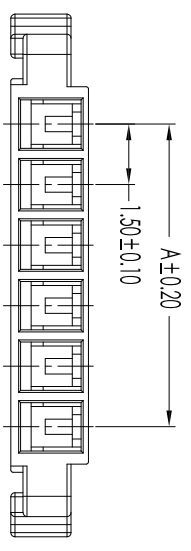
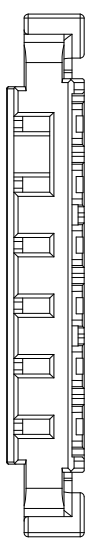

Item	Parts Material	Specification	Qty	Note	P/N
①	Insulator	Nylon 66(U94V0/ Color: Natural/White)	✕		A15002-HSG-66

Rev.	修正 Revisions	- Tolerances - Unless otherwise specified	
A.01	A1501WRS-S1-XP Tony 2015/06/13	公差	公差
B.01	变更料号 Tony 2020/07/21	连接器公差	连接器公差
		XX : ±0.25 D:±0.15	±0.5
		XXX : ±0.05 800-890 : ±0.20	
		X° : ±3°	L: ±0.90 : ±0.30

TEL: 86-769-8216714/6/87988875 MAIL: srco@qdsrco.com

东莞市盛瑞科技有限公司  
Dongguan Shengrui Technology Co., Ltd.

THIS DRAWING CONTAINS INFORMATION THAT IS PROPRIETARY TO SHENGRUI INCORPORATED AND SHOULD NOT BE USED WITHOUT WRITTEN PERMISSION.

机型 Model	-	核准 Approved	lan	05/13/20
客规 Customer P/N	-	审核 Checked	郑晨	05/13/20
盛瑞料号 Part No.	A-15006HSG-66-2-1	安规 Safety		
Environmental standard	ROHS	製圖 Draw	Tong	05/13/20
單位 Unit:mm	比例 Scale	頁碼 Page	1/1	

圖名 Description:  
Pitch: 1.50mm(Mx Ultra-thin) Cimp  
Style: housing latch type